



# Louisville Cooler Manufacturing



7635 NATIONAL TURNPIKE UNIT 130 LOUISVILLE, KY 40214

Toll Free 1-800-456-1440    FAX 502-363-3148    EMAIL info@lvc cooler.com

Web Site www.louisvillecooler.com



WE ARE NOW USING OZONE  
FRIENDLY NON-CFC FOAM





## **GENERAL SPECIFICATIONS WALK-IN COOLERS/FREEZERS**

### **1.0 General**

**1.1** Walk-in Coolers and Freezers to be constructed of prefabricated panels to allow convenient and accurate field assembly and future enlargement by the addition of panels.

**1.2** Walk-in Coolers & Freezers to be NSF.

**1.3** Insulation to be 25 flame spread – 450 smoke.

**1.4** Walk-in Coolers & Freezers to be UL approved for electrical components.

### **2.0 Panel Fabrication**

**2.1** Standard wall and ceiling panels shall be 47" and 23" width and shall be interchangeable with like panels. Standard height shall be 94" and 100" outside. Corner panels are to be 12" x 12" and ninety degrees for strength and ease of installation. Panels shall be of foamed in place urethane insulation sandwiched between interior and exterior metal substrate. Edges of panels shall be foamed in place tongue and groove with cam action locking devices. Locking devices are to be foamed in place at time of fabrication.

### **3.0 Floor Construction**

**3.1** Floor panels to be same as wall panels with the addition of reinforced inside pan. Floors to support 500 pounds per square foot of evenly distributed floor loads when panel is fully supported.

### **4.0 Insulation**

**4.1** Each panel shall be completely filled with rigid foamed in place urethane having a thermal conductivity (K- factor) of .145 BTU/hr. square foot per degrees Fahrenheit/inch; and overall coefficient of heat transfer (U-factor) of not more than .0362. R factor of 30. Insulation shall have 97% closed cell structure, with an average in place density 2.3 pounds per cubic foot, and a compression strength at yield point of 30 pounds per square inch. Overall thickness shall be 4 or 5" inches.

### **5.0 Metal Finishes**

**5.1** Standard metal finish shall be 26 gage stucco embossed galvalume interior and exterior.

**5.2** Optional metal substrate. Embossed aluminum .032, .040 mill finish. Appliance white .032, .040 smooth finish. Stainless steel 24 or 22 gage polished, 24 gauge USDA white galvanized.

### **6.0 Panel Locking Assemblies**

**6.1** Assembly of walk-ins shall be accomplished by cam action panel fasteners. Fasteners to be foamed in place and activated by hex key wrench provided with each unit. Access ports to be covered with cap plugs. Access on interior of boxes to allow assembly of walk-ins from inside.

**6.2** Ceiling panels and non standard panels shall have Louisville Cooler's unique, patented pin bar locking assembly.

### **7.0 Gaskets**

**7.1** Gaskets to be foamed in place to the male side (tongue) of all panels, on both interior and exterior. Gaskets to be impervious to stains, greases, oils, mildew, etc.

### **8.0 Entrance Door**

**8.1** Each walk-in shall be fitted with one standard 36" x 80" swing type door. The door shall be flush mounted in the door section. Door finish shall match the walls of the walk-in.

**8.2** Door shall be equipped with magnetic gasket, chrome latch and hinges. Safety inside release handle. Neoprene drag strip attached to bottom edge of door. Door jamb shall be heavy duty extruded aluminum.

### **9.0 Partitions**

**9.1** Construction and finish of partition walls to be the same as walk-in walls. Partition walls shall lock into walls, ceiling, and floor with cam action locks.

### **10.0 Options**

**10.1** Clear vinyl strip doors, 6" wide for coolers, 4" wide double over lap for freezers.

**10.2** Dial thermometer, 2 ½" exterior reading – 40 to + 60 degrees required for NSF.

**10.3** Hydraulic door closer (mounted at the top of door).

**10.4** Heated vent port 2 ½" diameter 120/1/160.

**10.5** Reach in doors, 24" x 30" – 24" x 60".

**10.6** Exterior door ramp.

**10.7** Interior door ramp.

**10.8** Aluminum kick plates.

**10.9** Vision panel 14" x 24", 14" x 14".

**11.0** Bumpers

**11.1** Heavy gage tread plate cart bumpers floor mounted.

**11.2** Wall mounted cart bumpers.



**PARTIAL CUSTOMER LIST AS SOLD  
THROUGH OUR NETWORK OF DEALERS**

**PAPA JOHN'S PIZZA (OVER 2800 STORES NATIONWIDE)  
DOMINO'S PIZZA (SAUDI ARABIA)  
HUNGRY HOWIE PIZZA AND SUBS  
JET'S PIZZA  
GUMBY'S PIZZA  
PIZZA HUT  
PIZZA MAGIA  
ARBY'S**

**SUPER AMERICA C-STORES  
UNITED DAIRY FARMERS C-STORES  
FIL ZONE FOOD MARTS  
THORTON OIL FOOD MARTS  
BUDDY'S MINI FOOD MARTS  
BR FOOD MARTS  
SHELL FOOD MARTS  
PIC-N-PUMP FOOD MARTS  
TUMBLEWEED RESTAURANT  
KENTUCKY FRIED CHICKEN  
BUEHLER BUY LOW FOOD STORES  
IGA  
MINIT MARTS  
KROGER  
SAV-A-LOT FOOD STORES  
SPEEDWAY  
CITGO  
GAS AMERICA  
EXXON**

**PJ FOOD SERVICE COMMISSARIES (10 TO DATE)  
MOBY DICK COMMISSARY  
SYD'S BAGEL COMMISSARY  
CARGILL MEATS, EMGE PACKING, EVANSVILLE, IN  
TYSON FOODS, MISSOURI, ARKANSAS, TEXAS  
QUAKER OATS, ST. LOUIS MO  
FARM BOY MEATS, EVANSVILLE, IN  
BALLARD'S SAUSAGE, WAYNE W. VA  
THOMAS POULTRY, E-TOWN, KY  
KEEBLER CO., TULSA, OK  
VIE de FRANCE, ALEXANDRIA, VA  
M.G. WALDBAUM, GAYLORD, MN  
DeWAFFEL BAKERS, LITTLE ROCK, AK  
GOOD HUMOR/BREYERS ICE CREAM, SIKESTON, MO, HAGERSTOWN, MD,  
GREEN BAY, WI  
TACKETT FARMS, ITTA BENA, MS  
RICH PRODUCTS, MURFEESBORO, TN  
DARE TO CARE, LOUISVILLE, KY  
LIQUID CARBONICS, SMITHFIELD, OH  
U.S. GOVERNMENT DEPARTMENT OF DEFENSE  
HEARTLAND CATFISH, ITTA BENA, MS  
SOUTHFRESH FARMS. INDIANOLA, MS  
PRIDE OF THE SOUTH CATFISH, BROOKSVILLE, MS  
INSTANT WHIP, ST. LOUIS, MO, INDIANAPOLIS, IN  
PRAXAIR  
GOLD MEDAL PRODUCTS, CINCINNATI, OH, INDIANAPOLIS, IN, GREENSBORO, NC  
INDIANAPOLIS FRUIT CO.**

**PLUS MANY DEALERS, REFRIGERATION CONTRACTORS AND REFRIGERATION  
WHOLESALEERS NATION WIDE.**



**VARIOUS JOBS WHERE OUR COOLERS AND  
FREEZERS HAVE BEEN INSTALLED**

University of Louisville (medical research lab)  
Bellarmine University (new science building)  
University of Iowa Hospital  
Jefferson County Jail (new commissary)  
Papa John's International (new Louisville Commissary)  
Papa John's Pizza (over 3000 stores)  
Papa John's International (Raleigh, Des Moines, Portland,  
Orlando, Rotterdam, Jackson, Denver, Pittsburg, Dallas,  
Puerto Rico, Anchorage and Honduras)  
Speedway Stores (50 +)  
Pizzahut (150+)  
Gomart  
Pizza Magia  
Little General  
Exxon  
CITGO  
Gold Medal Products (Indianapolis, Cincinnati, Greensboro,  
NC)  
Arapahoe County Morgue (Denver)  
Greater Clark County Schools  
University of Southern Indiana  
Southview Elementary (Anderson)  
Pendleton Reformatory  
West Minister Village  
Gaston Elementary  
McCormick Creek State Park  
Indiana University Chemistry labs (Bloomington)  
Casino Aztar

**OUR COOLERS HAVE BEEN EXPORTED AND  
INSTALLED IN THE FOLLOWING COUNTRIES**

Canada  
Mexico  
Honduras  
Venezuela  
Saudi Arabia  
Russia  
Argentina

## STANDARD FLUSH DOOR WITH OPTIONAL FEATURES

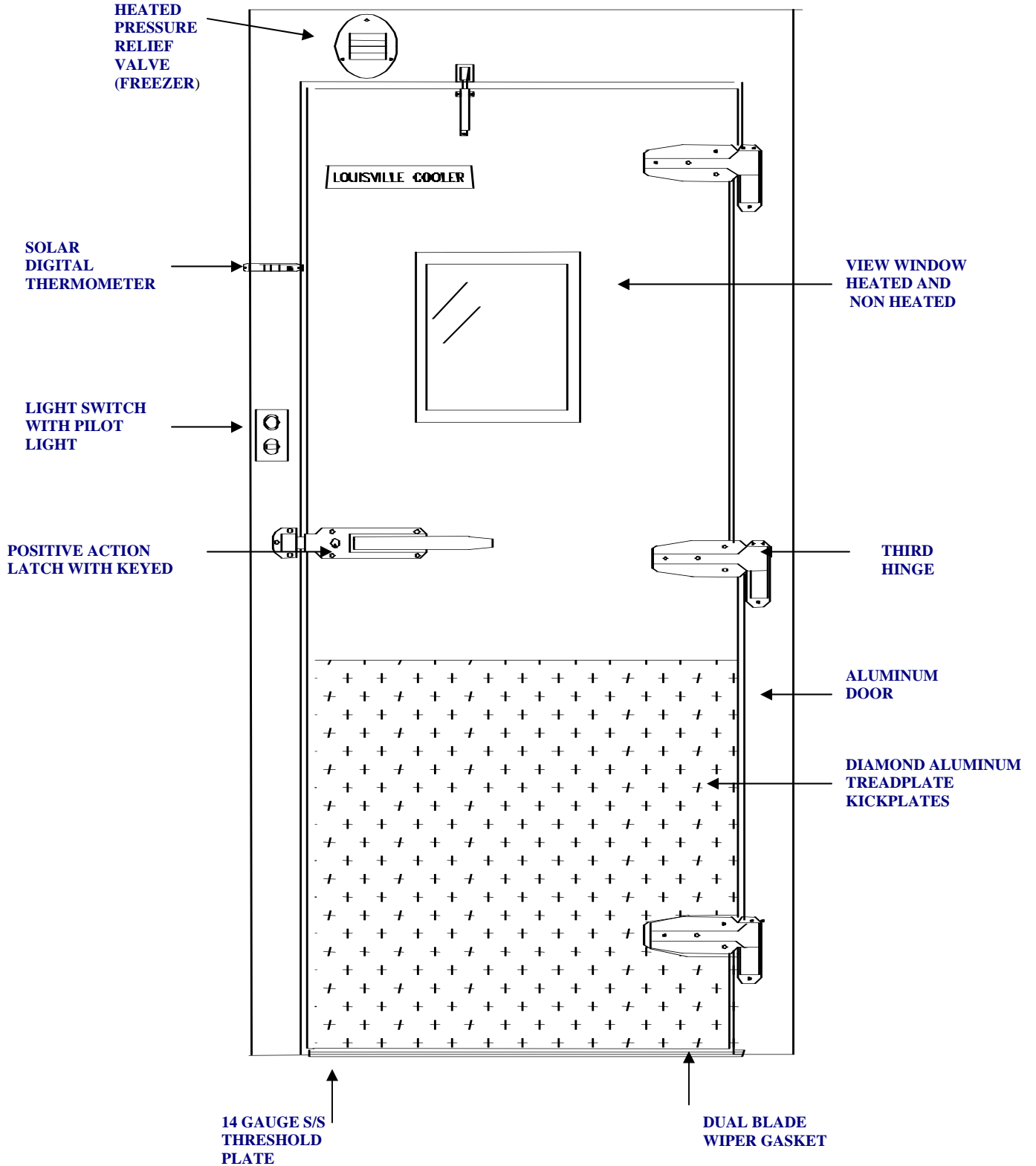

**STANDARD FLUSH DOOR  
(RIGHT HAND DOOR SHOWN)**

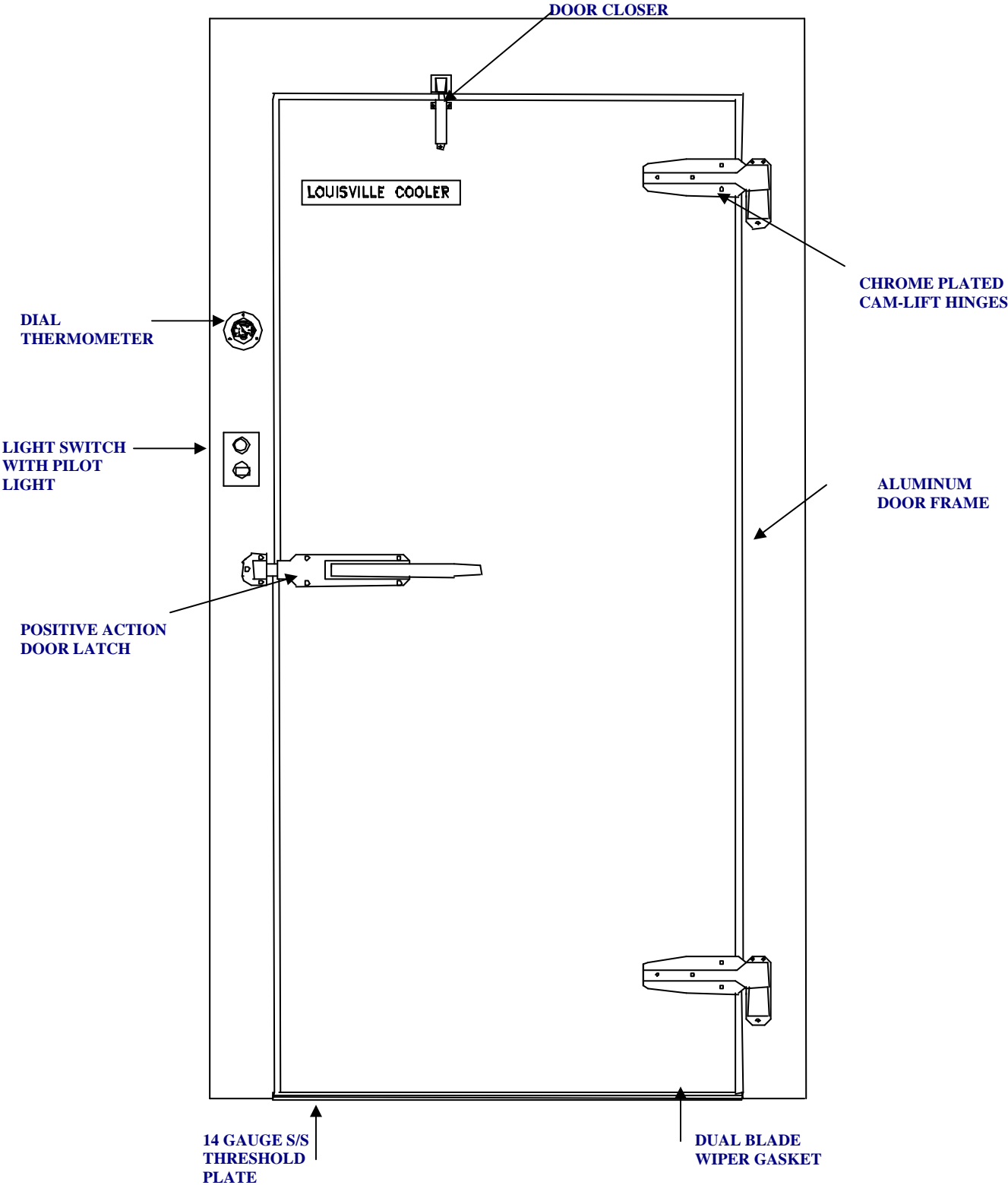



## ***RETRO-FIT DOORS & FRAMES***

***30" x 72" up to 60" x 96"***

### **APPLICATIONS**

**Replace damaged and worn Cooler and Freezer Doors with ease.**

**Improve energy costs by replacing that gaping door.**

**Enlarge existing openings to accommodate larger stock trucks and prevent future damage to your Walk-In.**

**Create new access areas in existing Walk-Ins.**

**METAL FINISHES:** 26 gauge embossed galvalume is standard.

**OPTIONAL FINISHES:**  
**Embossed Aluminum**

**Smooth White Aluminum**

**Smooth White Galvanized**

**Embossed White Galvanized**

**Stainless Steel**



### **SPECIFICATIONS**

**FRAMES:** Frames are three sided for applications with no floor and 4 sided for applications with floor. Standard frame width is 5-1/2".

**HARDWARE:** Cam lift hinges with nylon bearings, heavy duty handle with padlock provision, inside safety release and chrome finish.

**GASKETS:** Magnetic type replaceable, resistant to oils, fats, water and sunlight.

**HEATERS:** Freezers only are equipped with a 115 volt heater element concealed behind chrome strips on (3) sides and under threshold. Heaters are readily accessible for field replacement. Junction box is located at the top.

**INSULATION:** Each door is filled with rigid foamed in place urethane having a thermal conductivity (k-factor) of 118 BTU/HR. square foot per degrees Fahrenheit/inch: and an overall coefficient of heat transfer (u-factor) of not more than .029. R-factor of 34. Insulation shall have 97% closed cell structure, with an average in place density of 2.4 pounds per cubic foot.

**LOUISVILLE COOLER MANUFACTURING CO, INC.**

**7635 NATIONAL TURNPIKE Unit 130**

**LOUISVILLE, KENTUCKY 40214**

**1-800-456-1440 (502)363-1692 FAX (502)363-3148**

**info@lvc cooler.com**

**www.louisvillecooler.com**

RETRO-FIT DOOR WORKSHEET

EXISTING COOLER/FREEZER

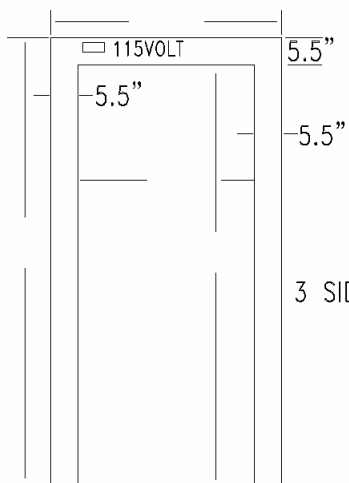

EXISTING COOLER/FREEZER

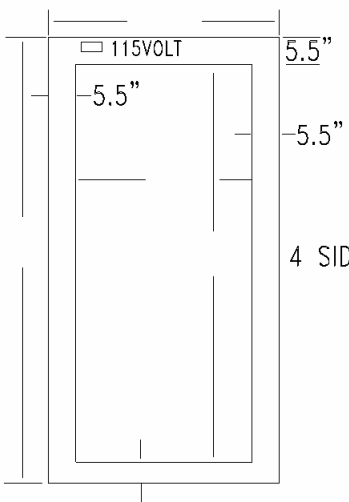

Provide the height and width of the existing opening as indicated by the open dimension lines to the left.

DESCRIPTION

COOLER \_\_\_\_\_ FREEZER \_\_\_\_\_  
 HINGED: LEFT \_\_\_\_ RIGHT \_\_\_\_

FRAME

3 SIDED \_\_\_\_\_ FOUR SIDED \_\_\_\_\_

FINISH

	<u>INTERIOR</u>	<u>EXTERIOR</u>
GALVALUME	_____	_____
ALUMINUM	_____	_____
STAINLESS	_____	_____
WHITE GALVANIZED	_____	_____
EMBOSSED WHITE	_____	_____

OPTIONS

KICKPLATE: \_\_\_\_\_  
 DOOR CLOSER: \_\_\_\_\_

SIZES AVAILABLE

30"X 72" UP TO 60"X 96"

CONTACT INFORMATION

TELEPHONE: 800-456-1440  
 FAX: 502-363-3148  
 E-MAIL: INFO@LVLCOOLER.COM  
 WEB SITE: WWW.LVLCOOLER.COM



# Louisville Cooler

## ***DOUGH CART BUMPERS***



**Dough Cart Bumpers are fabricated of Aluminum Treadplate custom fabricated to fit your specific requirements. Aluminum Treadplate is mitered to insure a tight joint in the corners. Sheet Metal screws and concrete anchors are provided to anchor bumpers to the walls and floor.**

Maintain the appearance of your Walk-In cooler and protect it from damage by dough carts, dollies and hand trucks.

By installing bumpers you also insure proper air flow around your product.



### **Louisville Cooler Manufacturing Co.**

7635 National Turnpike  
Unit 130  
Louisville, Kentucky 40214

Phone: 502-363-1692  
Fax: 502-363-3148  
Email: [info@LVLCOOLER.com](mailto:info@LVLCOOLER.com)

*Website: [www.louisvillecooler.com](http://www.louisvillecooler.com)*



**Louisville Cooler**

*WAREHOUSE  
COOLER & FREEZER  
PANELS*



**FOR INFORMATION CALL:**

[Louisville Cooler Manufacturing Co.](#)

7635 National Turnpike  
Unit 130  
Louisville, Kentucky 40214

Email: [Info@lvlcooler.com](mailto:Info@lvlcooler.com)

Phone: 502-363-1692

Fax: 502-363-3148

[www.louisvillecooler.com](http://www.louisvillecooler.com)



## ELECTRICAL INFORMATION

TYPICAL WIRING  
DIAGRAM FOR A  
WALK-IN COOLER  
DOOR

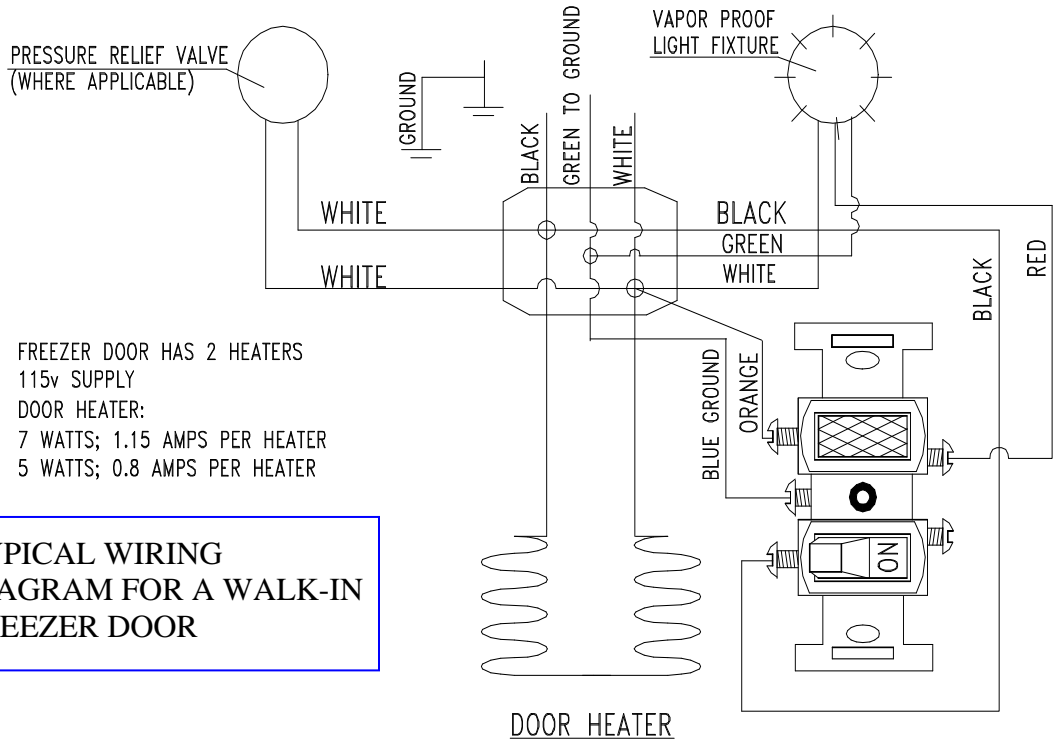
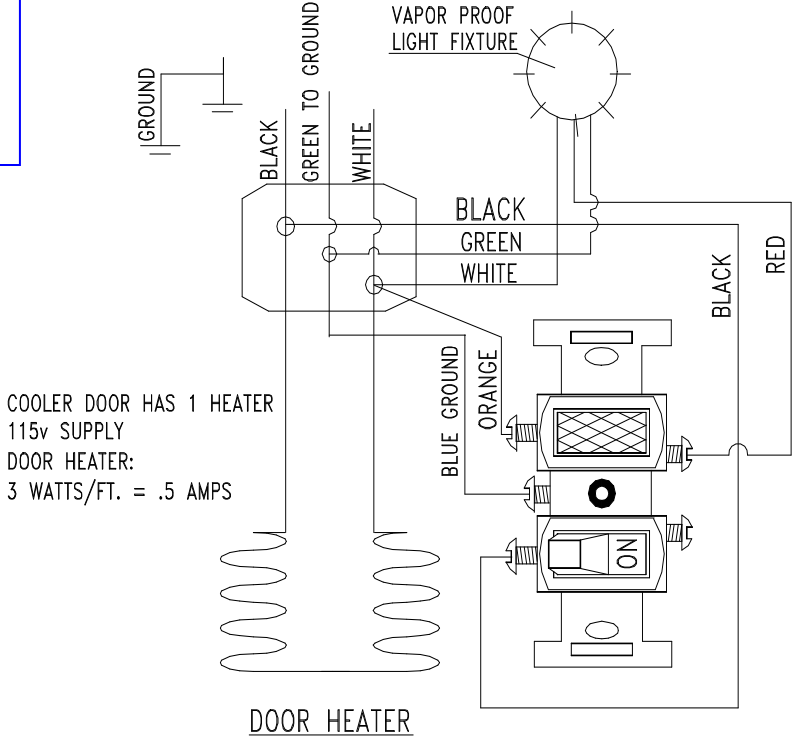

TYPICAL WIRING  
DIAGRAM FOR A WALK-IN  
FREEZER DOOR



**FLOORLESS INSTALLATION WITH INSULATED SLAB**

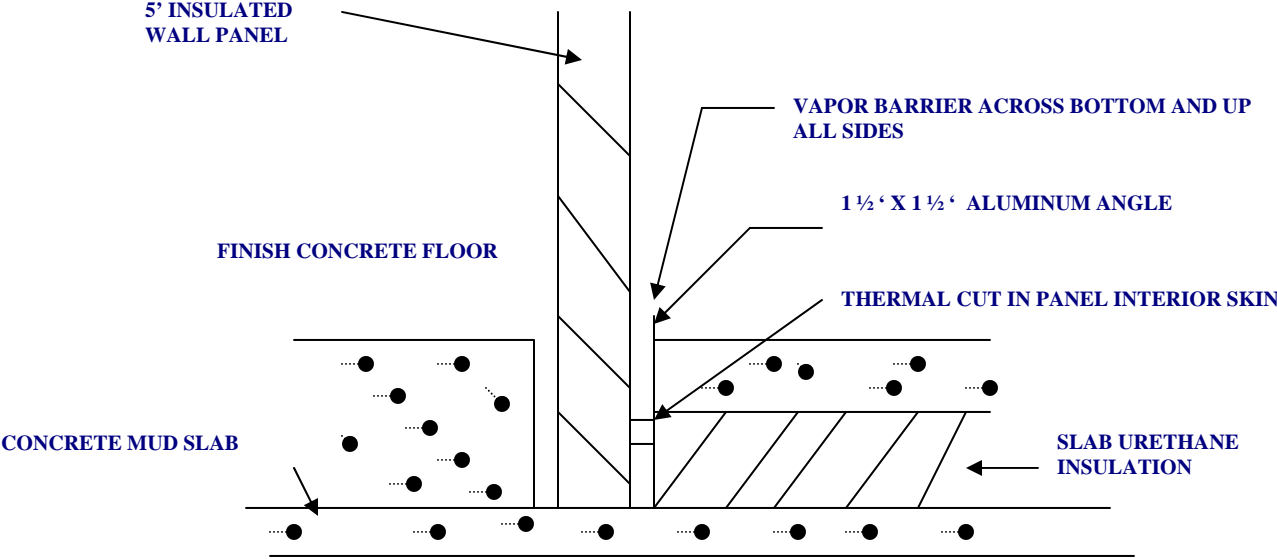



## QUICK SHIP REFRIGERATION

1/2 - 2-1/2 HP MOH HERMETIC CONDENSING UNITS						
MODEL NUMBER	COMPRESSOR NUMBER		STANDARD - OUTDOOR (CF)			APPROX. SHIP WGT. (LBS.)
			Outdoor unit (C) with added LL Drier & Timer			
			NET PRICES			
<b>MEDIUM TEMPERATURE</b>		<b>VOLTAGE</b>	<b>CALL FOR PRICING</b>			
MOH005D7	ART82C1	208/230/1				214
MOH008D7	RRG-0100	208/230/1				168
MOH010D7	RS70C1	208/230/1				163
MOH015D7	CRA-0150	208/230/1				226
MOH020D7	CRD-0200	208/230/1				230
<b>LOW TEMPERATURE</b>			<b>CALL FOR PRICING</b>			
MOH014L6	CF06K6E	208/230/1				197
MOH025L6	CFO9K6E	208/230/1				259
WALK-IN EVAPORATORS - LOW PROFILE						
<b>MEDIUM TEMPERATURE</b>						<b>APPROX. SHIP WGT. (LBS.)</b>
MODEL #	VOLTAGE		NET DIMENSIONS			
			HEIGHT	DEPTH	LENGTH	
LSC-065	115V		15	15	29.5	44
LSC-090	115V		15	15	45.5	58
LSC-104	115V		15	15	45.5	68
LSC-140	115V		15	15	61.5	70
LSC-156	115V		15	15	61.5	76
<b>LOW TEMPERATURE</b>						<b>APPROX. SHIP WGT. (LBS.)</b>
MODEL #	VOLTAGE		NET DIMENSIONS			
			HEIGHT	DEPTH	LENGTH	
LSF-075	208/230/1		15	15	45.5	60
LSF-090	208/230/1		15	15	45.5	74
LSF-120	208/230/1		15	15	61.5	102

LOUISVILLE COOLER MANUFACTURING CO.  
 7635 NATIONAL TURNPIKE  
 Unit 130  
 LOUISVILLE, KENTUCKY 40214

TELEPHONE: (502) 363-1692, 800-456-1440  
 FAX: (502) 363-3148  
 EMAIL: INFO@LVLCOOLER.COM

[www.louisvillecooler.com](http://www.louisvillecooler.com)